



DOOR MANAGEMENT SYSTEMS

Implementation devices for door management systems



5 devices with



5 different functions

Stop/go display
SLIM-DUALUX



Stop/go sensorized display
SLIM-DUALUX



Push-button unit
SLIM-DUALPUSH



Emergency "mushroom" button
SLIM-HELPPUSH

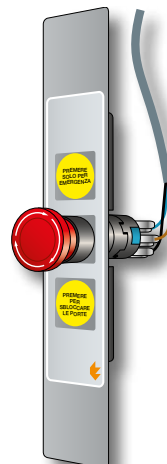

Intercom
SLIM-DUALVOX



in a unified & convertible format

NEW

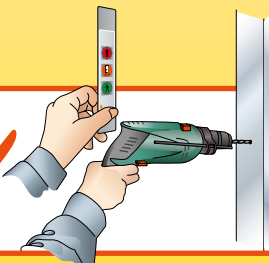

FLAT-DUALUX

ultra-slim stop/go display for easy installation

FOR AVAILABLE TYPES see pag. 80

SLIM & MODULAR

Ultra-slim and super-compact in a unified & convertible format.

Stop/go display
SLIM-DUALUX

Stop/go sensorized display
SLIM-DUALUX No-touch

Push-button unit
SLIM-DUALPUSH

Push-button with "mushroom"
SLIM-HELPPUSH

Intercom unit
SLIM-DUALVOX

Keypad
SLIM-CODEGUARD

Badge reader
SLIM-PASSGUARD

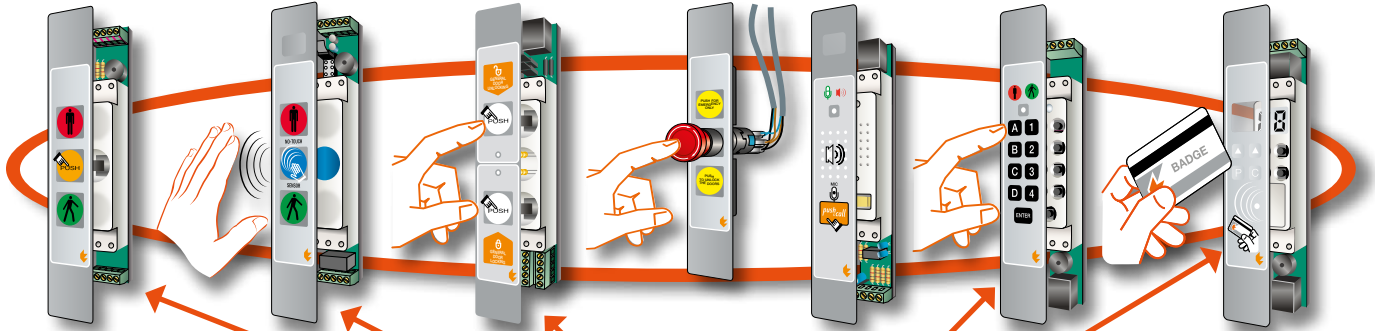

DOOR MANAGEMENT SYSTEMS

Unified module because....

A full SLIM & MODULAR range of devices with different functions, operations and purposes (stop and go displays, entryphones, keypads, such as code keypads, badge readers and micro stop and go display control units of the same series...) designed and made keeping a single module of the same size for all as a base element. In fact, all the devices have the same appearance, size and modularity to be interchangeable and housed in the same unified chasing of the previous lock.

Convertible because...

Using unified flanges, cases and boxes, any unified SLIM & MODULAR device is convertible into 5 different types that can be installed in any way, next to the door, based on the assembly needs found in the field.

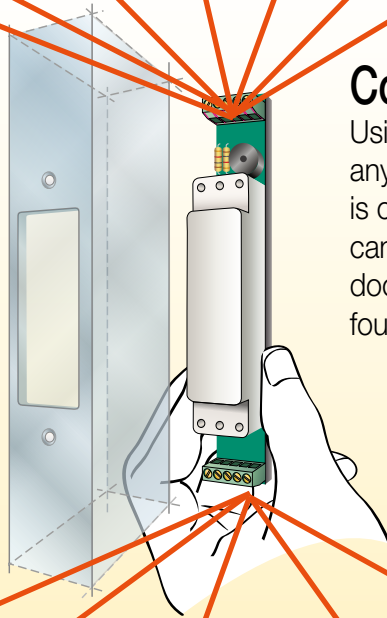

Assembly type

1

fully aligned concealed for recess-mounting without flange on the same plane of the door frame panel

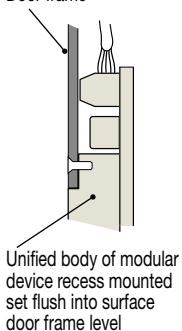

Assembly type

2

fully aligned at milling for recess-mounting with front flange on the same plane of the panel surface

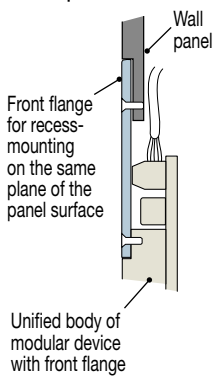

Assembly type

3

for conventional flush mounting with front flange overlapping door frame

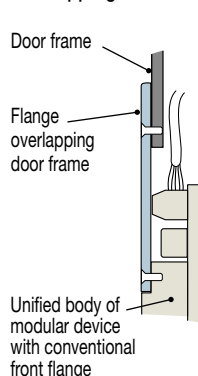

Assembly type

4

for surface mounting with using housing

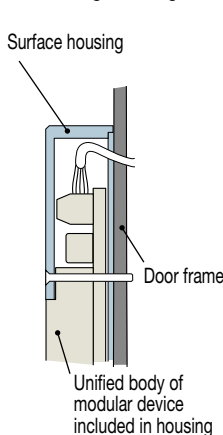



Assembly type

5

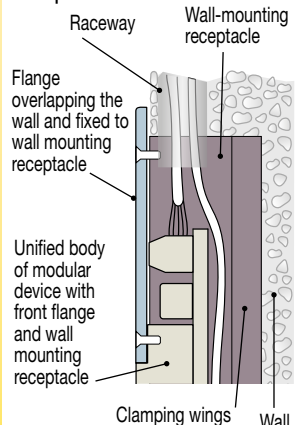
for recessed wall-mounting with flange and wall-mounting receptacle

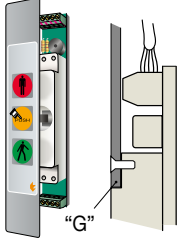
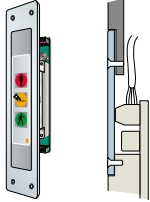
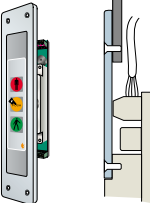
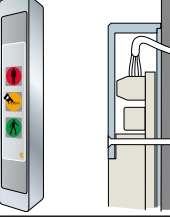
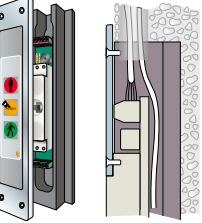

	<h2 style="color: orange;">SLIM-DUALUX</h2> <h3>PROFESSIONAL STOP/GO DISPLAYS</h3>	Export Product-list January 2024  TECNODIMENSIONE®
	<ul style="list-style-type: none"> - With 2 "screw-type" terminal boards for conventional cables - Green/red light + buzzer + multifunctional push button with "dry" changeover contacts (no voltage). - 1 self-adhesive cover in polycarbonate, 180 x 30 mm, R2,5, thickness 0.3 mm with international symbols, available in 7 colours. 	Ordering information 

Assembly type	Models for 12Vdc/70mA power supply	MODELS	N°
Assembly type 1 fully aligned concealed for recess-mounting without flange on the same plane of the door frame panel ✳ 	SLIM-DUALUX stop and go display type 1 with fully aligned concealed for recess-mounting on the same plane of the door frame panel without flange. Ideal to achieve a "smooth" surface (without roughness) that is easy to clean. Supplied with diffuser screen and gap G for sections with a thickness of 1.6 mm. Complete with self-adhesive cover designed to be applied after the final installation of the system. * In this case it is advisable to prepare the recess during the door frame machining.	034981CM2U	
	Same with diffuser screen and gap G for sections with a thickness of 3 mm.	034981CM2U3	
	Models for 24Vdc/40mA power supply (on request)		
	SLIM-DUALUX stop and go display same but with 24 Vdc/40mA power supply with diffuser screen with G gap for sections with a thickness of 1.6 mm	034981CM4U	
	Same with diffuser screen and gap G for sections with a thickness of 3 mm	034981CM4U3	
Assembly type 2 fully aligned at milling for recess-mounting with front flange on the same plane of the panel surface ◆ 	Models for 12Vdc/70mA power supply SLIM-DUALUX stop and go display type 2 for aligned recessed flush fitting in bottom of panel using front flange (e.g. To mount on wall panel next to the door frame on the post where no chasing can be carried out). Supplied with front flange in anodized aluminium with "silver" finish - 250 x 50 mm, thickness 2.5 mm for recess-mounting on the same plane of the panel surface for aligned recessed flush fitting in bottom of plane using front flange. Cover pre-assembled and fixed into the flange niche. ◆ In this case, it is advisable to prepare sunk milling during the panel machining phase.	034982CM2U	
	Models for 24Vdc/40mA power supply (on request)		
	SLIM-DUALUX stop and go display same but with 24 Vdc/40mA power supply	034982CM4U	
Assembly type 3 for conventional flush mounting with front flange overlapping door frame 	Models for 12Vdc/70mA power supply SLIM-DUALUX stop and go display type 3 for traditional recessed fitting using flange. Supplied with front flange in anodized aluminium with "silver" finish - 250 x 50mm, thickness 4 mm for flush mounting. Cover pre-assembled and fixed into the flange niche. Mounting can be carried out "on site", directly onto the installed door frame.	034983CM2U	
	Models for 24Vdc/40mA power supply (on request)		
	SLIM-DUALUX stop and go display same but with 24 Vdc/40mA power supply	034983CM4U	
Assembly type 4 for surface mounting with using housing 	Models for 12Vdc/70mA power supply SLIM-DUALUX stop and go display type 4 for mounting placed on surface using housing. With extra-strong protective housing, made in anodized silver finish aluminium (35 x 25 x 215 mm). Self-adhesive cover in polycarbonate, provided separately and designed to be used as final cover to hide the 4 fixing screws of the housing on the door frame. Useful when you wish to avoid recess-mounting or cuts on the door frame.	034984CM2U	
	Models for 24Vdc/40mA power supply (on request)		
	SLIM-DUALUX stop and go display same but with 24 Vdc/40mA power supply	034984CM4U	
Assembly type 5 for recessed wall-mounting with flange and wall-mounting receptacle 	Models for 12Vdc/70mA power supply SLIM-DUALUX stop and go display type 5 for recessed assembly using flange and wall box. Supplied with front flange in anodized aluminium with "silver" finish - 250 x 50 mm, thickness 4 mm, to be fixed to the housing by placing on wall surface. Self-adhesive cover in polycarbonate pre-assembled and fixed into the flange niche. Also fitted with wall box with "wings" for rapid anchoring (65 x 30 x 230 mm), in plastic taken from single block to be assembled "in a niche" in the wall to house the body of the stop and go display. Wall niche and cable channel to be prepared beforehand.	034985CM2U	
	Models for 24Vdc/40mA power supply (on request)		
	SLIM-DUALUX stop and go display same but with 24 Vdc/40mA power supply	034985CM4U	

Special configurations available at extra charge: Cover with your logo and/or customized.

For sizes, measurements and details of chasing, application examples and connection diagrams, see page 67.



SLIM-DUALUX No-touch PROFESSIONAL SENSORIZED STOP/GO DISPLAYS



- With 2 screw-type terminal box for conventional cables
- Green/red light + buzzer.
- Equipped (instead of manual pressure button) with an infrared sensor that "sees" a presence up to 10 cm away. The "contactless" door-opening command and/or alarm works automatically by bringing the hand close, without touching anything.

- On board 1A/12Vdc relay with a dry exit contact (no voltage), programmable NO or NC, using the jumper. Timed command with exit relay that starts and remains activated for 8 seconds, each time the hand comes near the No-touch sensor's range of action.
- 1 adhesive cover in polycarbonate, 180 x 30 mm, R2,5, thickness 0.3 mm with 7-colour international symbols.

Export Product-list

January 2024



TECNODIMENSIONE®

Ordering information



Q.ty

N°

Models for 12Vdc/70mA power supply

MODELS

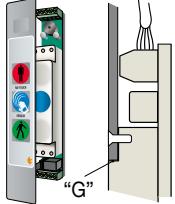
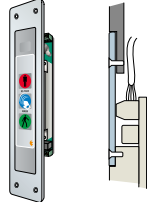
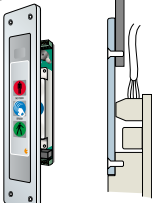
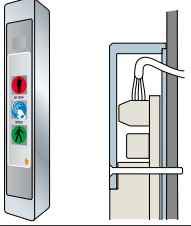
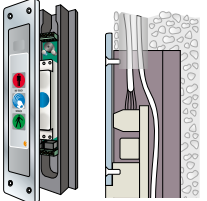
		MODELS	Q.ty	N°
Assembly type 1 fully aligned concealed for recess-mounting without flange on the same plane of the door frame panel ✱ 	SLIM-DUALUX No-touch stop and go display type 1 with fully aligned concealed for recess-mounting on the same plane of the door frame panel without flange. Ideal to achieve a "smooth" surface (without roughness) that is easy to clean. Supplied with diffuser screen and gap G for sections with a thickness of 1.6 mm. Complete with self-adhesive cover designed to be applied after the final installation of the system. * In this case it is advisable to prepare the recess during the door frame machining.	034981HM2U		
	Same with diffuser screen and gap G for sections with a thickness of 3 mm.	034981HM2U3		
Assembly type 2 fully aligned at milling for recess-mounting with front flange on the same plane of the panel surface ◆ 	SLIM-DUALUX No-touch stop and go display type 2 for aligned recessed flush fitting in bottom of panel using front flange (e.g. To mount on wall panel next to the door frame on the post where no chasing can be carried out). Supplied with front flange in anodized aluminium with "silver" finish - 250 x 50 mm, thickness 2.5 mm for recess-mounting on the same plane of the panel surface for aligned recessed flush fitting in bottom of plane using front flange. Cover pre-assembled and fixed into the flange niche. ◆ In this case, it is advisable to prepare sunk milling during the panel machining phase.	034982HM2U		
Assembly type 3 for conventional flush mounting with front flange overlapping door frame 	SLIM-DUALUX No-touch stop and go display type 3 for traditional recessed fitting using flange. Supplied with front flange in anodized aluminium with "silver" finish - 250 x 50mm, thickness 4 mm for flush mounting. Cover pre-assembled and fixed into the flange niche. Mounting can be carried out "on site", directly onto the installed door frame.	034983HM2U		
Assembly type 4 for surface mounting with using housing 	SLIM-DUALUX No-touch stop and go display type 4 for mounting placed on surface using housing. With extra-strong protective housing, made in anodized silver finish aluminium (35 x 25 x 215 mm). Self-adhesive cover in polycarbonate, provided separately and designed to be used as final cover to hide the 4 fixing screws of the housing on the door frame. Useful when you wish to avoid recess-mounting or cuts on the door frame.	034984HM2U		
Assembly type 5 for recessed wall-mounting with flange and wall-mounting receptacle 	SLIM-DUALUX No-touch stop and go display type 5 for recessed assembly using flange and wall box. Supplied with front flange in anodized aluminium with "silver" finish - 250 x 50 mm, thickness 4 mm, to be fixed to the housing by placing on wall surface. Self-adhesive cover in polycarbonate pre-assembled and fixed into the flange niche. Also fitted with wall box with "wings" for rapid anchoring (65 x 30 x 230 mm), in plastic taken from single block to be assembled "in a niche" in the wall to house the body of the stop and go display No-touch. Wall niche and cable channel to be prepared beforehand.	034983HM2U		

Special configurations available at extra charge: Cover with your logo and/or customized.

For sizes, measurements and details of chasing, application examples and connection diagrams, see page 69.

SLIM-DUALUX No-touch STOP & GO DISPLAYS - sizes, application examples and connection diagram

Assembly type 1 total alignment, lock recessed into surface without flange

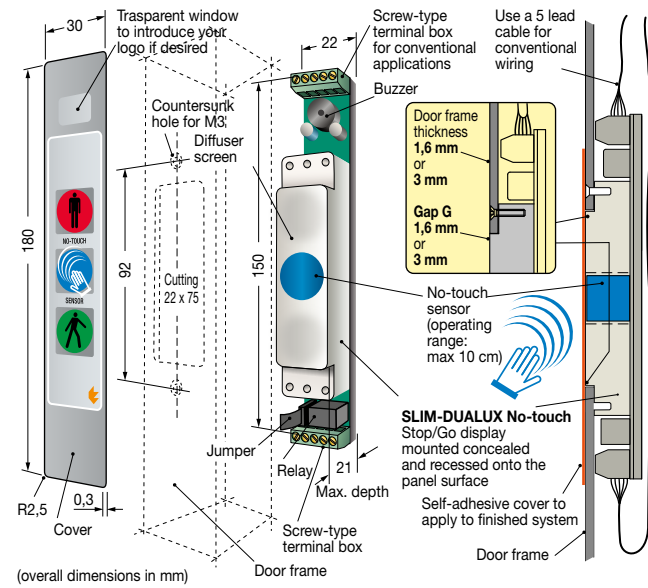

Assembly type 2 alignment at bottom with front flange "flush with surface" at bottom

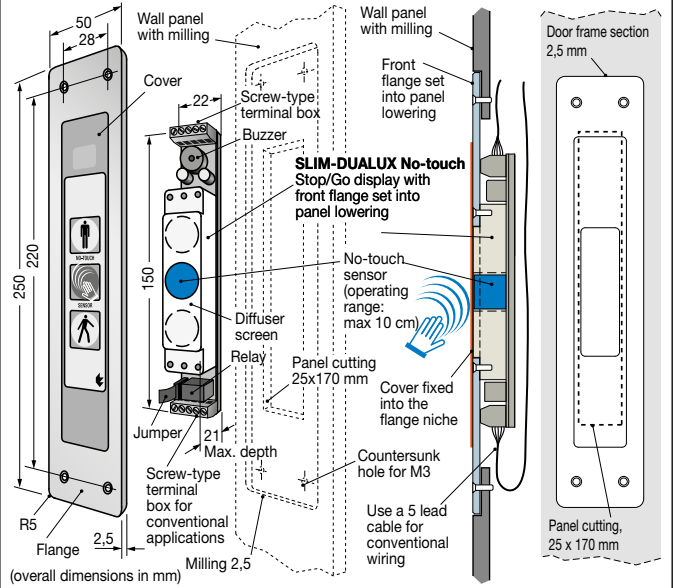

Assembly type 3 traditional fitting with front flange over the lock

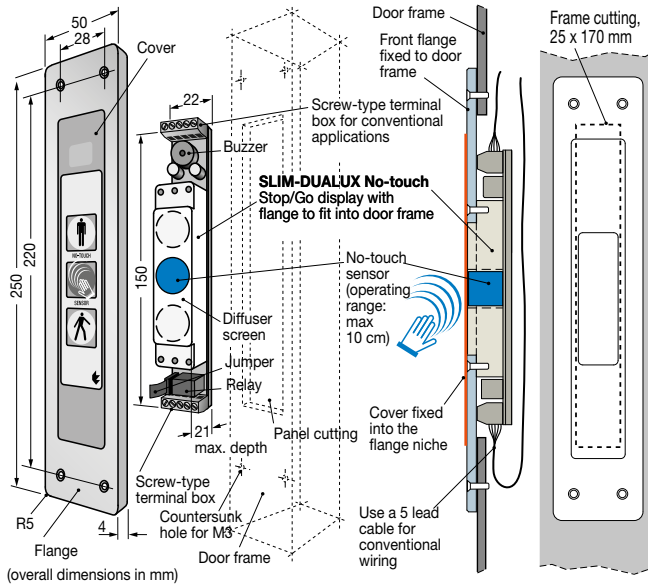

Assembly type 4 for mounting placed on surface using housing

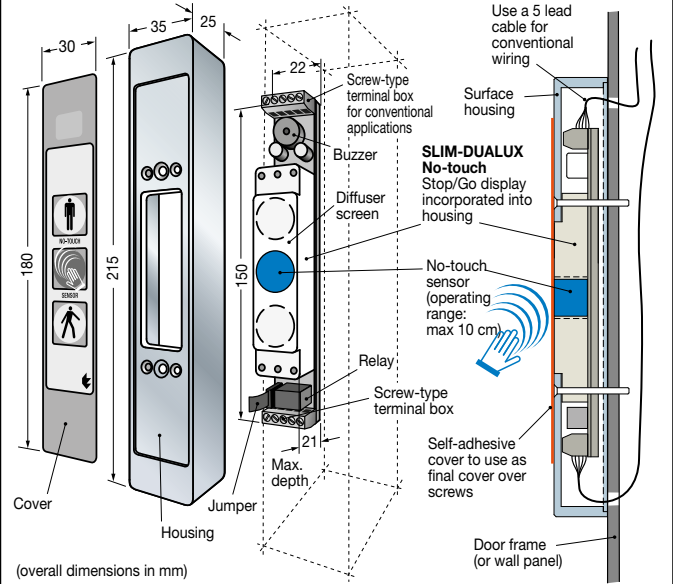

Assembly type 5 for recessed wall mounting with flange and wall box

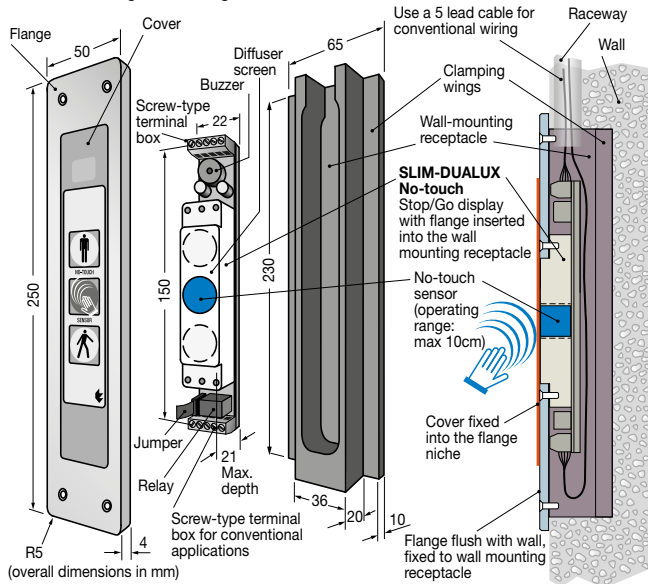

CONNECTION DIAGRAM valid for all 5 types

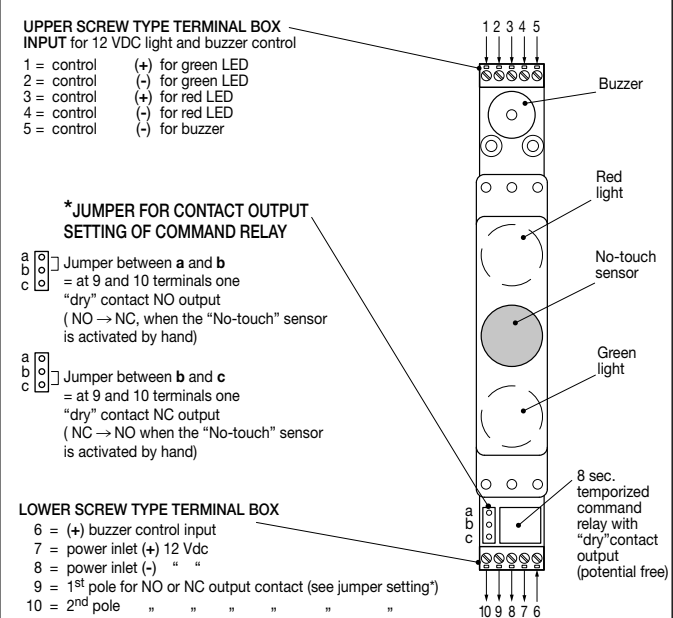

DOOR MANAGEMENT SYSTEMS